

Revised Record

1.0	New issue	2016-07-25	3.0	Change Resistor value and test condition	2016-09-26
2.0	Change Position of AK	2016-07-27	4.0	Change the PIN of Backlight	2017-08-23
			5.0	Change the PIN location of Backlight	2018-03-15

1.INTERNAL CIRCUIT DIAGRAM

A=ANODE  
K=CATHODE

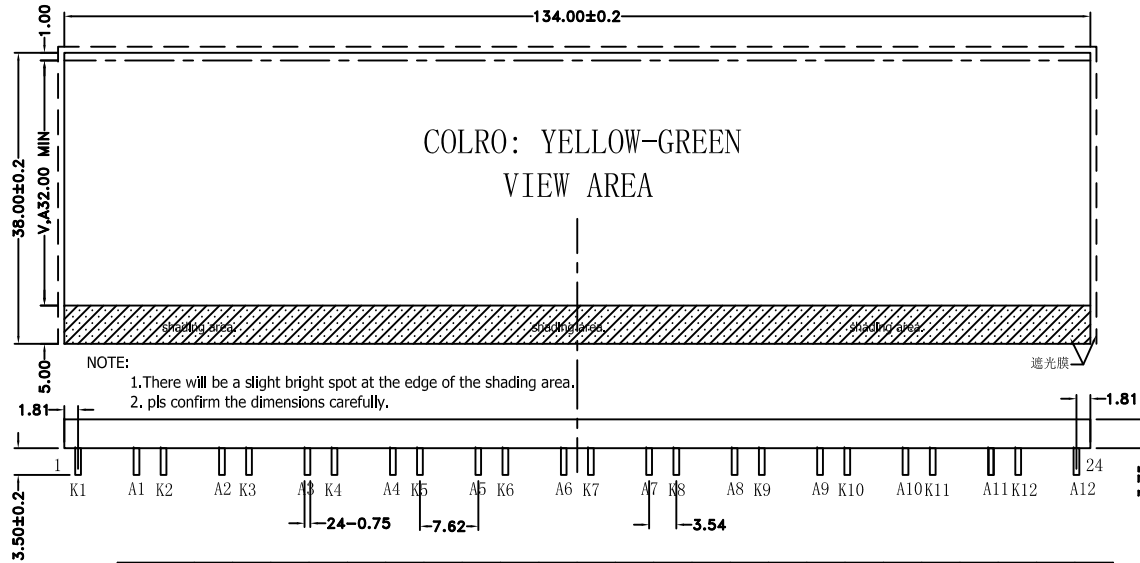

PIN	1	2	3	4	5	6	7	8	9	10	11	12	13	14	15	16	17	18	19	20	21	22	23	24
FUNCTION	K1	A1	K2	A2	K3	A3	K4	A4	K5	A5	K6	A6	K7	A7	K8	A8	K9	A9	K10	A10	K11	A11	K12	A12

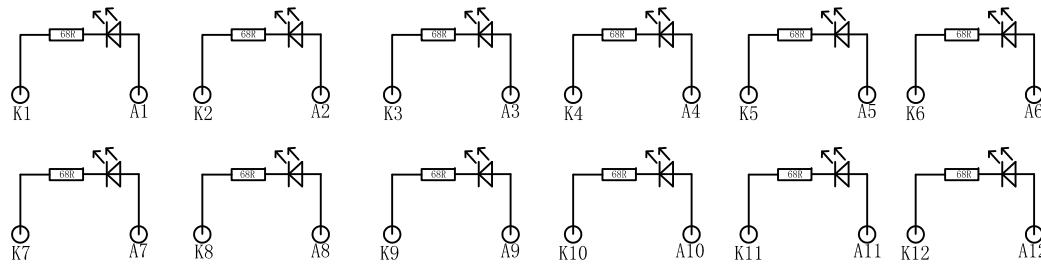

2.MEASURED METHODE ("HOLD" DIAMETER  
ø7.7& DISTANCE:50CM)  
(Effective Spatial Destrubtion)  
1 to 5 per-Position Measured Luminous Intensity.

Tester:Spectra Scan (BM7)1°

UNIFORMITY:  $\frac{MIN}{MAX} \times 100\% \geq 70\%$

Intensity = \_\_cd/m<sup>2</sup>

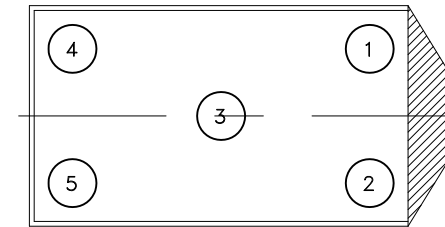

ELECTRICAL / OPTICAL SPECIFICATIONS

PARAMETER	SYMBOL	Min.	Typ.	Max	Unit	Test condition
AVERAGE LUMINOUS INTENSITY	Iv	TBD	150		cd/m <sup>2</sup>	(Yellow-Green color) Ta=25°C If=12*15mA
UNIFORMITY		80	—	—	%	
FORWARD VOLTAGE	Vf	3.9	4.0	4.1	V	
PEAK EMISSION WAVELENGTH	P	568	—	574	nm	
CHROMATICITY COORDINATES	X Y	— —	— —	— —	— —	

I-T diagram

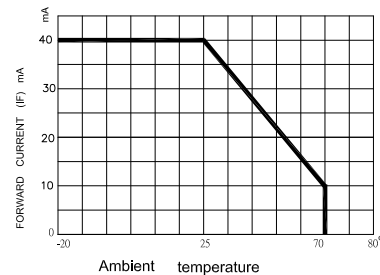

NOTE :

- All the dimensions of the tooling base on this preliminary spec.
- The brightness is reference only, the data base on first artical.

ABSOLUTE MAXIMUM RATING

ITEM	SYMBOL	RATING	Unit	TEST CONDITION
FORWARD CURRENT	If	15	mA	Ta=25°C
REVERSE VOLTAGE	Vr	5.0	Volt	
POWER DISSIPATION	Pd	110	mW	
OPERATING TEMPERATURE	Topr	-20 ~ +70	°C	
STORAGE TEMPERATURE	Tstg	-30 ~ +80	°C	

**BLAZE** Blaze Display Technology Co.,Ltd.

DESIGNED BY: BDT-12

BL-B13438-01

VERSION: 5.0

CHECKED BY: BDT-06

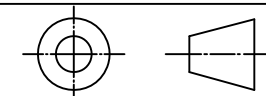

PAGE 1 OF 1

APPROVED BY: BDT-01

UNIT: mm

Website: <http://www.blazedisplay.com>

DATE: 2018-03-15