

PRODUCT NUMBER
SEE TABLE

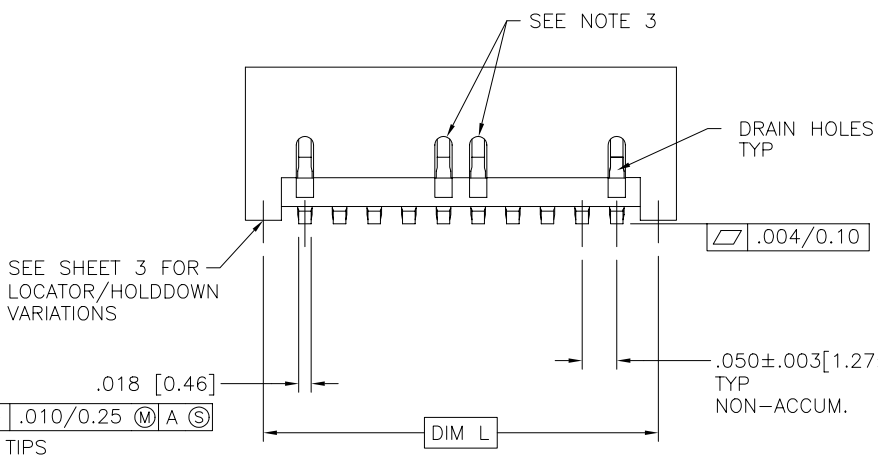
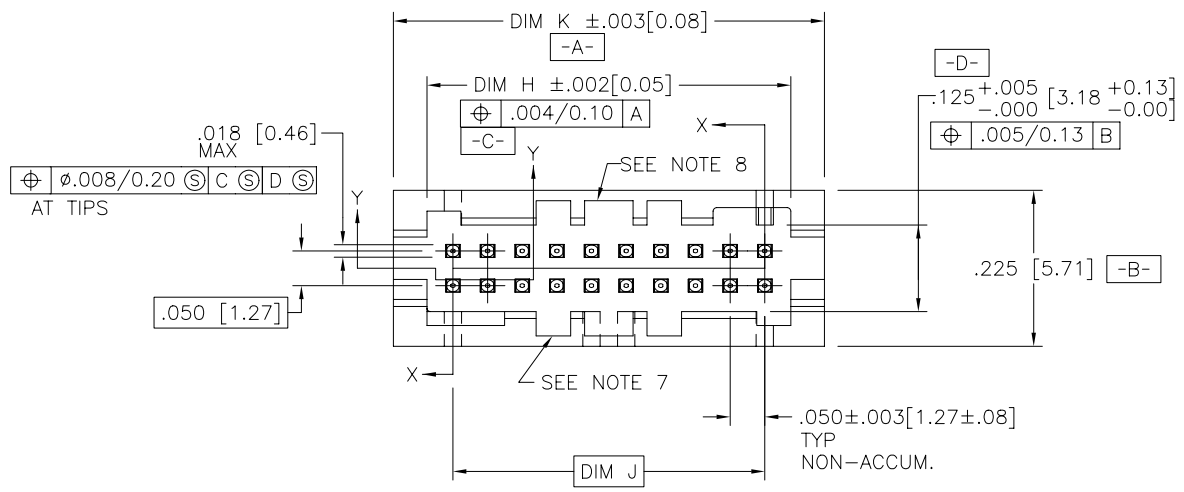

mat'l. code		surface		tolerance		projection		product family	
SEE NOTES		ISO 1302 <input checked="" type="checkbox"/>		ISO 406				RIB CAGE	
ISO 1101		tolerances unless otherwise specified		xx $\pm .01 / .3$		INCH/MM		title	
ltr	ecn no	dr	date	angles	linear	xxx $\pm .005 / .13$		RIB CAGE III SMT	
S	v02340	DAI	9/20/00			xxxx $\pm .0020 / .050$		VERT. HEADER ASS'Y	
T	v10994	CRG	3/15/01			scale 1:1		dwg no	
U	v11295	CRG	4/25/01	$\sigma \pm 2'$				sheet 1 of 6 size	
V	j10329	CRG	6/06/01	dr	M. CORNMAN	6/07/95		A3	
W	v04-0004	DAI	1/21/04	enfr	D. WHITING	6/07/95		95781	
X	M05-084	MHT	5/05/05	chr	D. WHITING	6/07/95		type	
Y	M06-0284	AEA	7/27/06	appd	D. WHITING	6/07/95		Product Customer Drawing	
sheet index	revision	Y	Y	Y	Y	Y	Y		
	sheet	1	2	3	4	5	6		

Copyright FCI
 FCIconnect.com

PRODUCT NUMBER
SEE TABLE

SIZE	DIM H	DIM J	DIM K	DIM L
2X5	.275/6.99	.200/5.08	.372/9.45	.320/8.13
2X10	.525/13.34	.450/11.43	.622/15.80	.570/14.48
2X15	.775/19.68	.700/17.78	.872/22.15	.820/20.83
2X20	1.025/26.03	.950/24.13	1.122/28.50	1.070/27.18
2X25	1.275/32.38	1.200/30.48	1.372/34.85	1.320/33.53
2X30	1.525/38.74	1.450/36.83	1.622/41.20	1.570/39.88
2X35	1.775/45.08	1.700/43.18	1.872/47.55	1.820/46.23
2X40	2.025/51.43	1.950/49.53	2.122/53.90	2.070/52.58
2X45	2.275/57.78	2.200/55.88	2.372/60.25	2.320/58.93
2X50	2.525/64.14	2.450/62.23	2.622/66.60	2.570/65.28

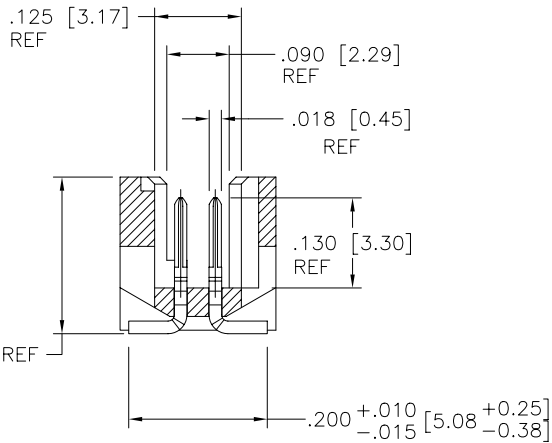

SECTION X-X
ROTATED 90° CW

⊕ .010/.25 ⊗ B

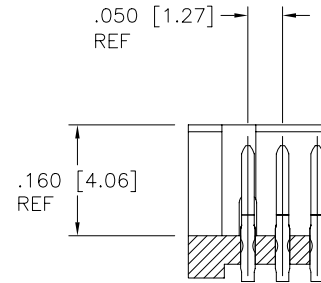

SECTION Y-Y

mat'l. code SEE NOTES		surface ISO 1302 ✓	tolerance ISO 406 ISO 1101	projection ⊕	product family RIB CAGE
ltr	ecn no	dr	date	tolerances unless otherwise specified	title
Y				angles linear xx ±.01/.3 xxx ±.005/.13 xxxx ±.0020/.050	RIB CAGE III SMT VERT. HEADER ASS'Y
				σ±2'	INCH/MM scale 1:1
		dr	M. CORNMAN	6/07/95	dwg no
		enfr	D. WHITING	6/07/95	sheet 2 of 6
		chr	D. WHITING	6/07/95	size 95781 A3
		appd	D. WHITING	6/07/95	type Product Customer Drawing
sheet index	revision sheet				



PRODUCT NUMBER
SEE TABLE

LOCATOR/HOLDDOWN VARIATIONS

STYLE
1

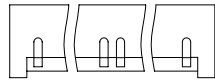

STYLE
2

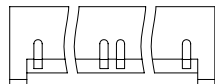

$\phi .0520$ [1.321]
 $\phi .004/0.10$ (M) A (S) B (S) (ALL PEG CONFIGURATIONS)

STYLE
3

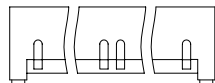

R.0050 [0.127]
 $\phi .0394$ [1.000]
.028 [0.71]
.024 [0.61]

STYLE
4

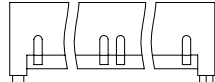

$\phi .034 \pm .001$ [0.86 ± .03]
.008 [0.20] X 45°
.0520^{+0.0005}/_{-.0010} [1.321^{+0.013}/_{-.025}]
.0030 [0.076]
.040^{+0.001}/_{-.002} [1.02^{+0.03}/_{-.05}]
.008 ± .003 [0.20 ± .08]

STYLE
5

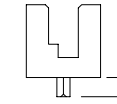
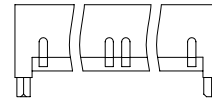

.0580 [1.473]
.0470^{+0.0005}/_{-.0010} [1.194^{+0.013}/_{-.025}]
.0470^{+0.0005}/_{-.0010} [1.194^{+0.013}/_{-.025}]
.040^{+0.001}/_{-.002} [1.02^{+0.03}/_{-.05}]
.040^{+0.001}/_{-.002} [1.02^{+0.03}/_{-.05}]

STYLE
6
SEE NOTE 9

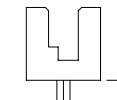
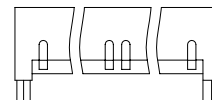

.120 [3.04]
.0520^{+0.0005}/_{-.0010} [1.321^{+0.013}/_{-.025}]
.0520^{+0.0005}/_{-.0010} [1.321^{+0.013}/_{-.025}]
.040^{+0.001}/_{-.002} [1.02^{+0.03}/_{-.05}]
.040^{+0.001}/_{-.002} [1.02^{+0.03}/_{-.05}]

STYLE
7

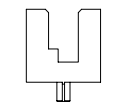
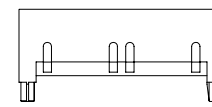

.0065 ± .001
[.165 ± .025]
 $\phi .0400$ [1.02]
.052 ± .001
[1.32 ± .025]
R.002 [0.05] MAX

mat'l. code SEE NOTES		surface ISO 1302 ✓	tolerance ISO 406 ISO 1101	projection INCH/MM	product family RIB CAGE
ltr	ecn	no	dr	date	title
Y					RIB CAGE III SMT VERT. HEADER ASS'Y
		angles	linear	xx ±.01/.3 xxx ±.005/.13 xxxx ±.0020/.050	scale 1:1
		dr	M. CORNMAN	6/07/95	dwg no
		enr	D. WHITING	6/07/95	95781
		chr	D. WHITING	6/07/95	sheet 3 of 6 size A3
		appd	D. WHITING	6/07/95	type Product Customer Drawing
sheet index	revision sheet				



FCIconnect.com

Copyright FCI

form: A3

PRODUCT NUMBER
SEE TABLE

RECOMMENDED PCB MOUNTING PAD PATTERN

STYLE 1

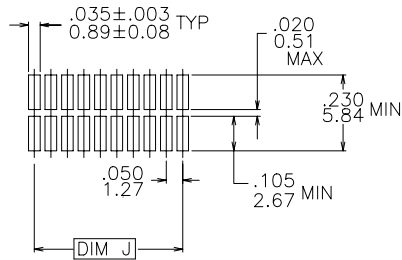

STYLE 5

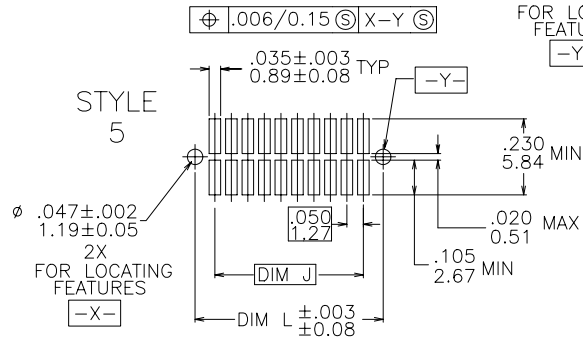

STYLE 4

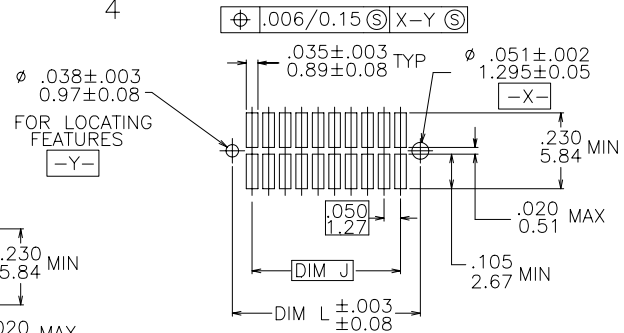

STYLE 6

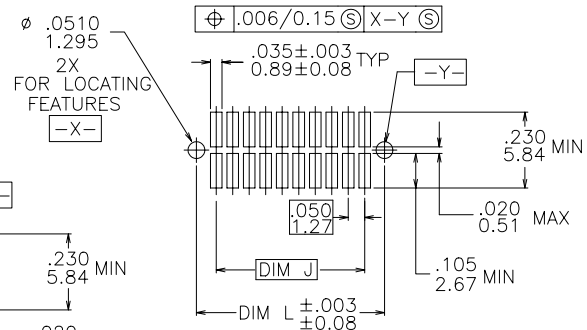

STYLE 2

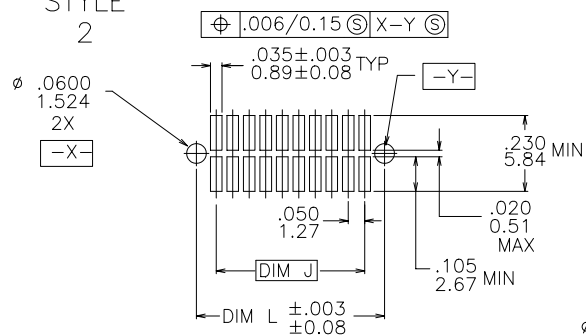

STYLE 7

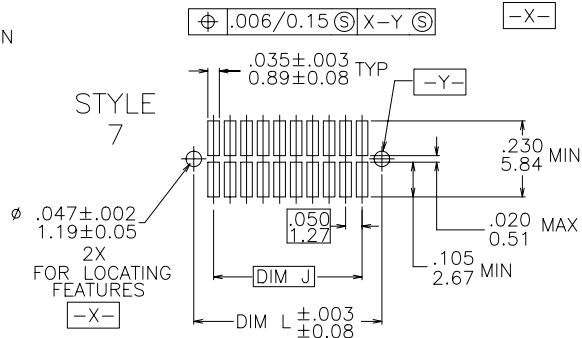

STYLE 3

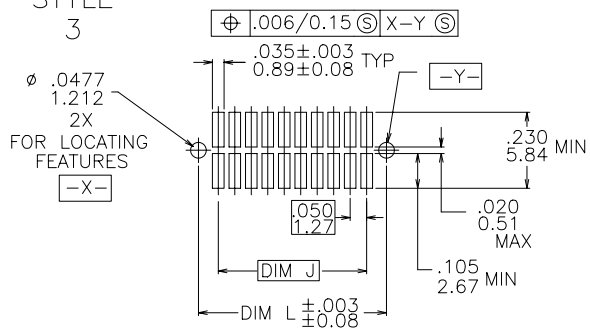

mat'l. code SEE NOTES		surface ISO 1302 ✓	tolerance ISO 406 ISO 1101	projection ⊕	product family RIB CAGE
ltr	ecn	no	dr	date	title
tolerances unless otherwise specified					INCH/MM
Y					
		angles	linear	xx ±.01/.3	RIB CAGE III SMT
				xxx ±.005/.13	VERT. HEADER ASS'Y
		σ±2'		xxxx ±.0020/.050	scale 1:1
		dr	M. CORNMAN	6/07/95	dwg no
		enrg	D. WHITING	6/07/95	sheet 4 of 6
		chr	D. WHITING	6/07/95	size
		appd	D. WHITING	6/07/95	A3
sheet index		revision			type
		sheet			Product Customer Drawing



Copyright FCI

PRODUCT NUMBER NOTE 1,4A & 4B	DIM P HEIGHT ABOVE BOARD (REF.)	HOLDDOWN STYLE
72428-1XX	.244/6.20	1
73546-1XX	.364/9.25	1
73547-1XX	.364/9.25	2
73548-1XX	.364/9.25	4
84700-1XX	.226/5.74	7
84701-1XX	.298/7.57	7
84734-1XX	.364/9.25	7
87401-1XX	.226/5.74	6
87409-1XX	.226/5.74	2
87849-1XX	.226/5.74	1
88566-1XX	.260/6.60	2
90098-1XX	.298/7.57	2
90863-1XX	.226/5.74	1
91036-1XX	.364/9.25	5
91423-1XX	.226/5.74	2
91855-1XX	.226/5.74	5
92099-1XX	.226/5.74	4
92412-1XX	.298/7.57	4
93206-1XX	.226/5.74	3
93221-1XX	.298/7.57	1
93289-1XX	.298/7.57	5

TABLE A

* CUSTOMER SPECIAL

SEE NOTE 10

*

NOTES:

- ① XXXXX-XXXLF
LEAD FREE OPTION (NOTE 11& 13)
NUMBER OF POSITIONS (NOTE 2)
- ② NUMBER OF POSITIONS = 05 THRU 50 IN 5 POS INCREMENTS.
(EXAMPLE : 105=10 POS., 110=20 POS. ETC.)
- ③ REQUIRED ON -X40,-X45 & -X50 POSITION PARTS ONLY.
- 4. PACKAGING :
A. ANTISTATIC TUBES. SEE TABLE A
B. ADD "CT" TO END OF DASH NUMBER FOR CONNECTOR WITH VACUUM CAP IN ANTISTATIC TUBES.
EX. : XXXXX-1XXCT
C. PRESSURE SEALED TAPE AND REEL. SEE TABLE C FOR AVAILABLE PART NUMBERS.
- ⑤ HOUSING MATERIAL :
GLASS FILLED THERMOPLASTIC FLAME RETARDANT PER UL 94V-0.
COLOR : BLACK
- ⑥ TERMINAL PLATING :
30u"/.76u HARD Au OVER 50u"/1.27u Ni ON CONTACT ZONES.
100u"/2.54u TIN LEAD OVER 50u"/1.27u Ni IN SOLDERING ZONES.
LEAD FREE OPTION:
30u"/.76u HARD Au OVER 50u"/1.27u Ni ON CONTACT ZONES.
100u"/2.54u PURE TIN OVER 50u"/1.27u Ni IN SOLDERING ZONES.
- ⑦ MOLDING FLOW RESTRICTOR QUANTITY AND LOCATION IS MANUFACTURING OPTION.
- ⑧ VACUUM CAP SLOT REQUIRED ON ALL SIZES, SLOT MAY BE LOCATED ON OPPOSITE SIDE FOR 2 X 5.
- ⑨ STYLE 6 IS NOT AVAILABLE IN TAPE AND REEL.
- ⑩ 90863-1XX IS PACKAGED ONLY IN TAPE AND REEL.
- ⑪ ADD LF SUFFIX AT THE END OF PART NUMBER FOR LEAD FREE OPTION.
- 12. THE HOUSING WILL WITHSTAND EXPOSURE TO 260°C PEAK TEMPERATURE FOR 20 SECONDS IN A CONVECTION, INFRA-RED OR VAPOR PHASE REFLOW OVEN. SEE APPLICATION NOTE/PROCEDURES IF THEY ARE AVAILABLE.
- ⑬ THIS PRODUCT MEETS EUROPEAN UNION DIRECTIVES AND OTHER COUNTRY REGULATION AS DESCRIBED IN GS-22-008.



FCIconnect.com

Copyright FCI

mat'l. code SEE NOTES		surface ISO 1302 ✓	tolerance ISO 406 ISO 1101	projection ⊕	product family RIB CAGE
ltr	ecn no/dr	date	tolerances unless otherwise specified	INCH/MM	title
Y			angles linear xx ±.01/.3 xxx ±.005/.13 xxxx ±.0020/.050	scale 1:1	RIB CAGE III SMT VERT. HEADER ASS'Y
		dr	M. CORNMAN	6/07/95	dwg no
		enr	D. WHITING	6/07/95	95781
		chr	D. WHITING	6/07/95	sheet 5 of 6 size A3
		appd	D. WHITING	6/07/95	type Product Customer Drawing
sheet index	revision sheet				

PRODUCT NUMBER	QTY. REEL	TAPE WIDTH PITCH MM	CONNECTOR ORIENTATION IN TAPE POCKET
NOTE 11,4C			
72428-120TR	500	44/12	VIEW 1
73547-110TR	↑	24/12	↑
84700-105TR		24/12	
84700-135TR		56/12	
87409-115TR		44/12	
87409-120TR		44/12	
87409-125TR		56/12	
87409-130TR		56/12	
87409-140TR		72/12	
87849-110TR		24/12	
87849-115TR		44/12	
87849-120TR		44/12	
87849-125TR		56/12	
87849-130TR	500	56/12	
88566-110TR	750	24/12	
88566-115TR	500	44/12	
88566-130TR	500	56/12	
90863-110	↑	24/12	↓
90863-115		44/12	VIEW 1
90863-115REV		44/12	VIEW 2 *
90863-120		44/12	VIEW 1
90863-125		56/12	↑
90863-130		56/12	
91036-110P		24/16	
93206-115TR		44/12	
93221-105TR		24/12	
93221-110TR		32/12	
93221-125TR	500	56/12	VIEW 1

TABLE C

* CUSTOMER SPECIAL
NO VACUUM CAP

REFERENCE ONLY :

TAPE WIDTH 32mm AND ABOVE HAS BOTH FEED TRACKS,
BELOW 32mm HAS TOP FEED TRACK ONLY.

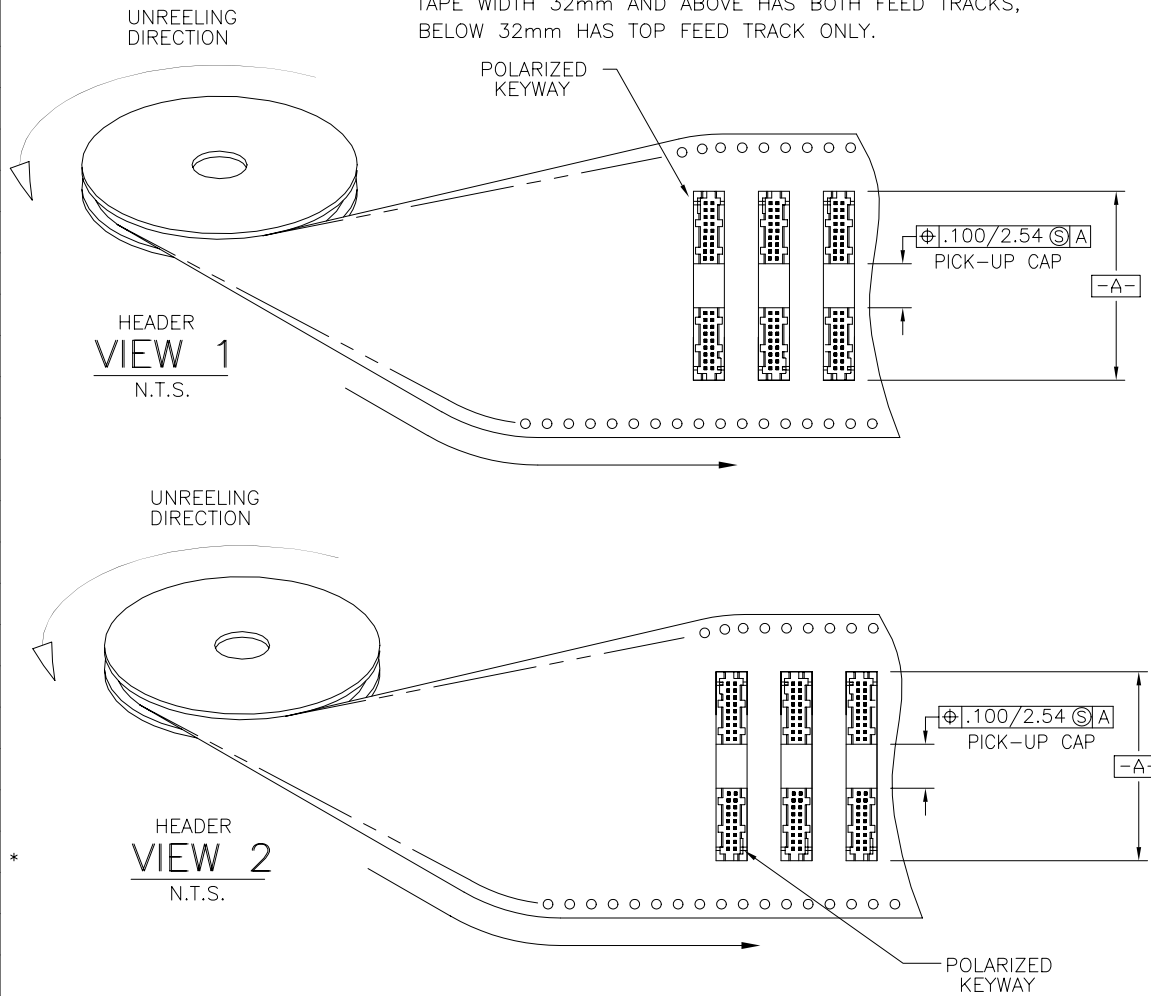

mat'l. code SEE NOTES		surface ISO 1302 ✓	tolerance ISO 406 ISO 1101	projection ⊕	product family RIB CAGE
ltr	ecn no/dr	date	tolerances unless otherwise specified	INCH/MM	title
Y			angles linear xx ±.01/.3 xxx ±.005/.13 xxxx ±.0020/.050	scale 1:1	RIB CAGE III SMT VERT. HEADER ASS'Y
		dr	M. CORNMANN	6/07/95	dwg no
		enr	D. WHITING	6/07/95	95781
		chr	D. WHITING	6/07/95	sheet 6 of 6
		appd	D. WHITING	6/07/95	size A3
sheet index	revision sheet				type Product Customer Drawing

