

CSM0310D Series (SHIELDED)

SMD Wire Wound Power Inductors

MECHANICAL DIMENSIONS

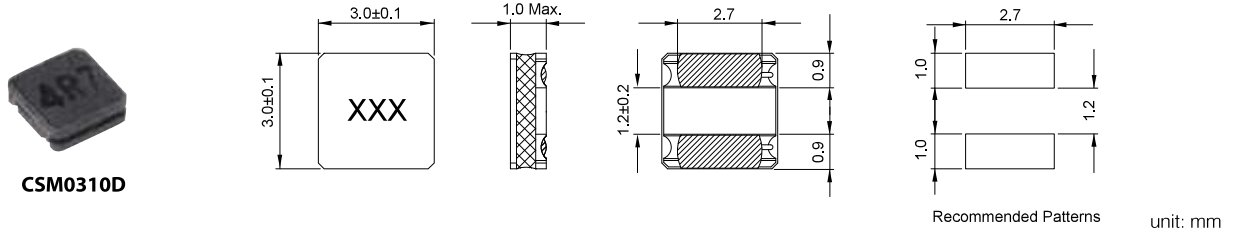

ELECTRICAL SPECIFICATION

Part Number	Marking	Inductance (μH)	Test Freq. (MHz)	DCR (Ω)	Isat (A)	Irms (A)	Inductance Tolerance
				Max.	Max.	Max.	
CSM0310D-1R0N-LRH	1R0	1.00	1	0.078	1.70	1.525	M: ±20% N: ±30%
CSM0310D-1R5N-LRH	1R5	1.50	1	0.096	1.40	1.470	
CSM0310D-2R2M-LRH	2R2	2.20	1	0.114	1.25	1.270	
CSM0310D-2R7M-LRH	2R7	2.70	1	0.169	1.00	1.020	
CSM0310D-3R3M-LRH	3R3	3.30	1	0.192	0.90	1.130	
CSM0310D-3R6M-LRH	3R6	3.60	1	0.215	0.95	0.900	
CSM0310D-4R7M-LRH	4R7	4.70	1	0.228	0.85	0.925	
CSM0310D-5R6M-LRH	5R6	5.60	1	0.342	0.72	0.820	
CSM0310D-6R8M-LRH	6R8	6.80	1	0.360	0.66	0.710	
CSM0310D-100M-LRH	100	10.0	1	0.540	0.53	0.630	
CSM0310D-150M-LRH	150	15.0	1	0.888	0.42	0.475	
CSM0310D-180M-LRH	180	18.0	1	0.793	0.42	0.470	
CSM0310D-220M-LRH	220	22.0	1	1.176	0.36	0.430	
CSM0310D-270M-LRH	270	27.0	1	1.404	0.30	0.350	
CSM0310D-330M-LRH	330	33.0	1	1.860	0.28	0.345	
CSM0310D-390M-LRH	390	39.0	1	2.275	0.28	0.280	
CSM0310D-470M-LRH	470	47.0	1	2.400	0.24	0.270	

- Tolerance: N= ± 30% ; M= ± 20%
- Test Equipment:
L/Q: CHROMA CH-3302, HP 4286A or equivalent.
RDC: CHROMA 16502 or equivalent.
- Isat: Based on Inductance decrease 30% (at 20°C)
- Iirms: Based on Temperature increase 40°C (at 20°C)
- Operating temperature Range: -40°C to +125°C (Including self-temperature rise)
- Storage Temp.: -40°C to +85°C

CHARACTERISTIC CURVE

CSM0310D Series

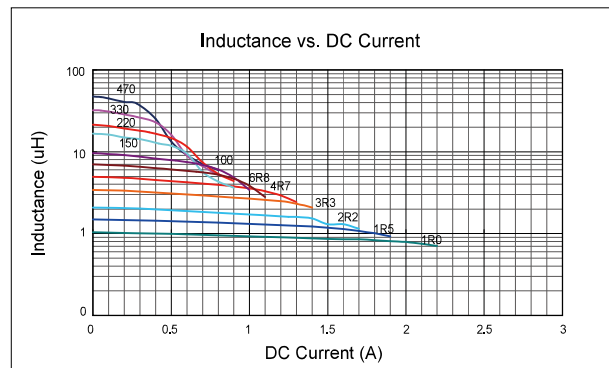
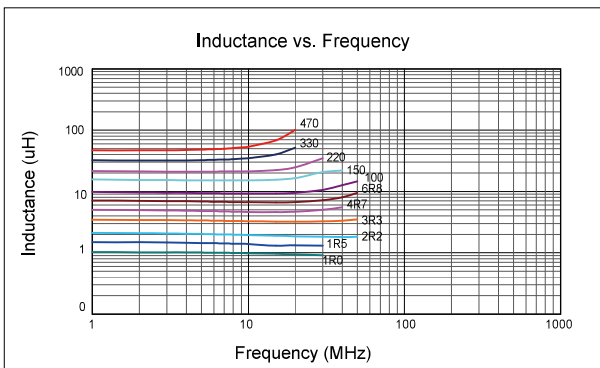

SMD

Leaded