

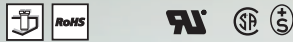

Type 101

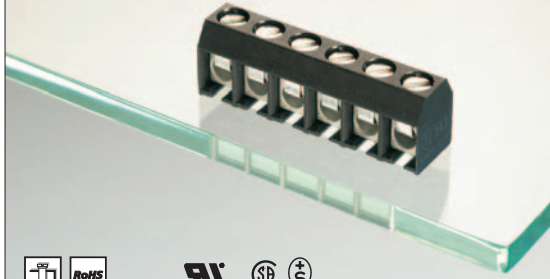

Type 15

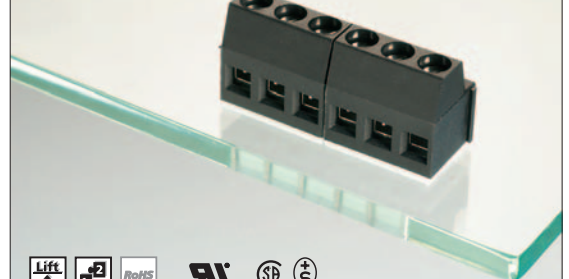

Note for wire range

Additional wire sizes and/or combinations of same size wires as follows:

Type 15

- # 2 No. 22 - 18 AWG (field-wiring);
- 2 No. 30 - 18 AWG or
- 1 No. 30 - 14 AWG (factory-wiring)

Description Type 101

Screw type terminal block, solderable, centerline 5.08 mm / 0.200 inches, horizontal wire entry, wire protector

Technical Data Type 101

- V / A / AWG 300 / 15 / 28 - 14
- V / A / AWG 300 / 15 / 28 - 14
Screw torque max. 7 lbs.-in
- 0.08 - 1.5 mm² 125 V / 2.5 kV / 3 / 13 A
Insulation co-ordination according to IEC 60664-1
Clearance and creepage distance ≥ 2.7 mm
Screw torque max. 0.5 Nm

Wire diameter	single wire 0.3 - 1.6 mm
Wire strip length	6 mm / 0.236 in.
Solder pin	0.9 mm / 0.035 in. dia. recommended pc board hole dia. 1.3 mm / 0.051 in.
Solder pin length	3.8 mm / 0.149 in.
Pole size	2 to 22
Colour	black

Dimensions in mm 1 mm = 0.0394 in.

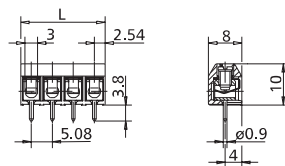

L = (pole size - 1) x centerline + 5.08 mm / 0.200 in.

Description Type 15

Screw type terminal block, solderable, centerline 5.08 mm / 0.200 inches, horizontal wire entry, lift system, modular

Technical Data Type 15

- V / A / AWG 300 / 15 / 22 - 14 # (see note)
- V / A / AWG 300 / 15 / 22 - 14 # (see note)
Screw torque max. 8 lbs.-in
- 0.08 - 1.5 mm² 250 V / 2.5 kV / 3 / 13 A
Insulation co-ordination according to IEC 60664-1
Clearance and creepage distance ≥ 3.9 mm
Screw torque max. 0.5 Nm

Wire diameter	single wire 0.3 - 2 mm
Wire strip length	7 mm / 0.236 in.
Solder pin	0.8 x 1 mm 0.031 x 0.039 in. recommended pc board hole dia. 1.4 mm / 0.055 in.
Solder pin length	4.1 mm / 0.161 in.
Pole size	2, 3
Colour	black

Dimensions in mm 1 mm = 0.0394 in.

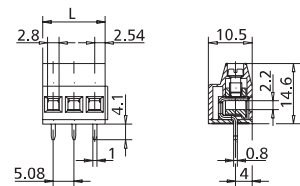

L = (pole size - 1) x centerline + 5.08 mm / 0.200 in.

Type 101 centerline 5.08 mm / 0.200 in.

P/N 311011 __ 02 03 04 05 06 07
08 09 10 11 12 (pole size)
- complete the part number by adding the pole size to the blank __
- other pole sizes consult factory

Type 15 centerline 5.08 mm / 0.200 in.

P/N 310151 __ 02 03 (pole size)
- complete the part number by adding the pole size to the blank __
- other pole sizes consult factory