

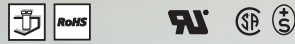

# Type 171

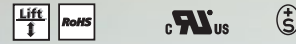

# Type 175

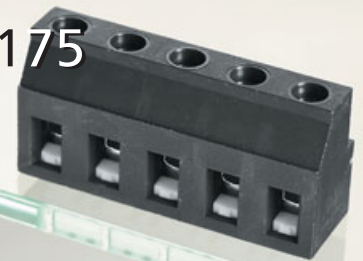

## Description Type 171

Screw type terminal block, solderable, centerline 7.5 mm / 0.295 inches, horizontal wire entry, wire protector

## Technical Data Type 171

- V / A / AWG 300 / 15 / 26 - 14
- V / A / AWG 300 / 15 / 26 - 14  
Screw torque max. 7 lbs.-in
- 0.08 - 2.5 mm<sup>2</sup> 500 V / 6 kV / 3 / 16 A  
Insulation co-ordination according to IEC 60664-1  
Clearance and creepage distance ≥ 5.8 mm  
Screw torque max. 0.5 Nm

Wire diameter	single wire 0.3 - 2.2 mm
Wire strip length	8 mm / 0.315 in.
Solder pin	1 mm / 0.039 in. dia. recommended pc board hole dia. 1.3 mm / 0.051 in.
Solder pin length	3 mm / 0.118 in.
Pole size	2 to 12
Colour	black

Dimensions in mm 1 mm = 0.0394 in.

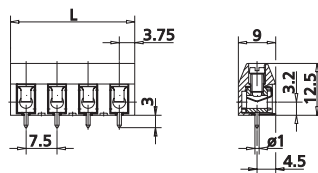

$L = (\text{pole size} - 1) \times \text{centerline} + 7.5 \text{ mm} / 0.295 \text{ in.}$

## Description Type 175

Screw type terminal block, solderable, centerline 7.5 mm / 0.295 inches, horizontal wire entry, wire protector

## Technical Data Type 175

- V / A / AWG 300 / 20 / 22 - 12
- Screw torque max. 6 lbs.-in
- 0.08 - 2.5 mm<sup>2</sup> 500 V / 6 kV / 3 / 16 A  
Insulation co-ordination according to IEC 60664-1  
Clearance and creepage distance ≥ 6.5 mm  
Screw torque max. 0.5 Nm

Wire diameter	single wire 0.3 - 2.7 mm
Wire strip length	8 mm / 0.315 in.
Solder pin	0.8 x 1 mm 0.031 x 0.039 in. recommended pc board hole dia. 1.4 mm / 0.055 in.
Solder pin length	4.1 mm / 0.161 in.
Pole size	2 to 12
Colour	black

Dimensions in mm 1 mm = 0.0394 in.

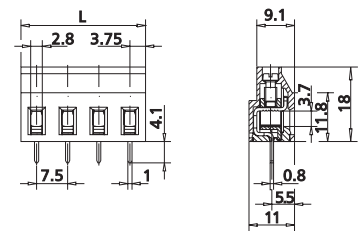

$L = (\text{pole size} - 1) \times \text{centerline} + 7.5 \text{ mm} / 0.295 \text{ in.}$

## Type 171 centerline 7.5 mm / 0.295 in.

P/N 311711 02 03 04 05 06 07  
08 09 10 11 12 (pole size)  
- complete the part number by adding the pole size to the blank \_\_\_  
- other pole sizes consult factory

## Type 175 centerline 7.5 mm / 0.295 in.

P/N 311751 02 03 04 05 06 07  
08 09 10 11 12 (pole size)  
- complete the part number by adding the pole size to the blank \_\_\_  
- other pole sizes consult factory